

Legend

- Order Limits
- Sheet Boundary
- Land Subject to Temporary Occupation and Use and Freehold Acquisition
- Land Subject to Temporary Occupation and Use and Acquisition of Permanent Rights
- Land Subject to Temporary Occupation and Use



06	21/05/2021	PR	Sixth Issue - Removed plot 10, amended Plots 12 and 13
05	16/04/2021	PR	Fifth Issue - Amended Plot 13
01	07/10/2019	PR	First Issue
Rev	Date	By	Comment

Prepared:	PR
Checked:	IM
Approved:	HH

1:25,000
Scale @ A1

0 500 1,000 2,000 Metres

Coords: 640,168 260,128

Source: © Crown copyright and database rights 2020. Ordnance Survey 0100031673.
This map has been produced to the latest known information at the time of issue, and has been produced for your information only. Please consult with the SPR GIS team to ensure the content is still current before using the information contained on this map. To the fullest extent permitted by law, we accept no responsibility or liability (whether in contract, tort (including negligence) or otherwise in respect of any errors or omissions in the information contained in the map and shall not be liable for any loss, damage or expense caused by such errors or omissions.

East Anglia ONE North Offshore Wind Farm

Land Plans (Onshore) Key Plan: Sheet 1 of 1

Drg No	180476_PLN_DCO_1820.0	
Rev	06	British National Grid OSGB36
Date	21/05/2021	
APFP Ref: 5(2)(i)		Doc ref: 2.2.2

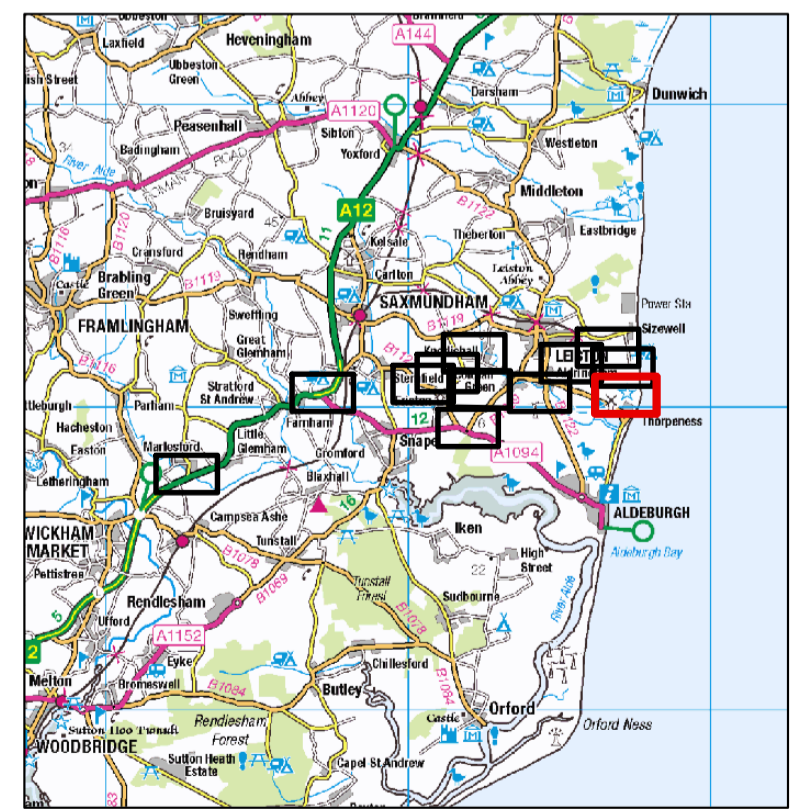
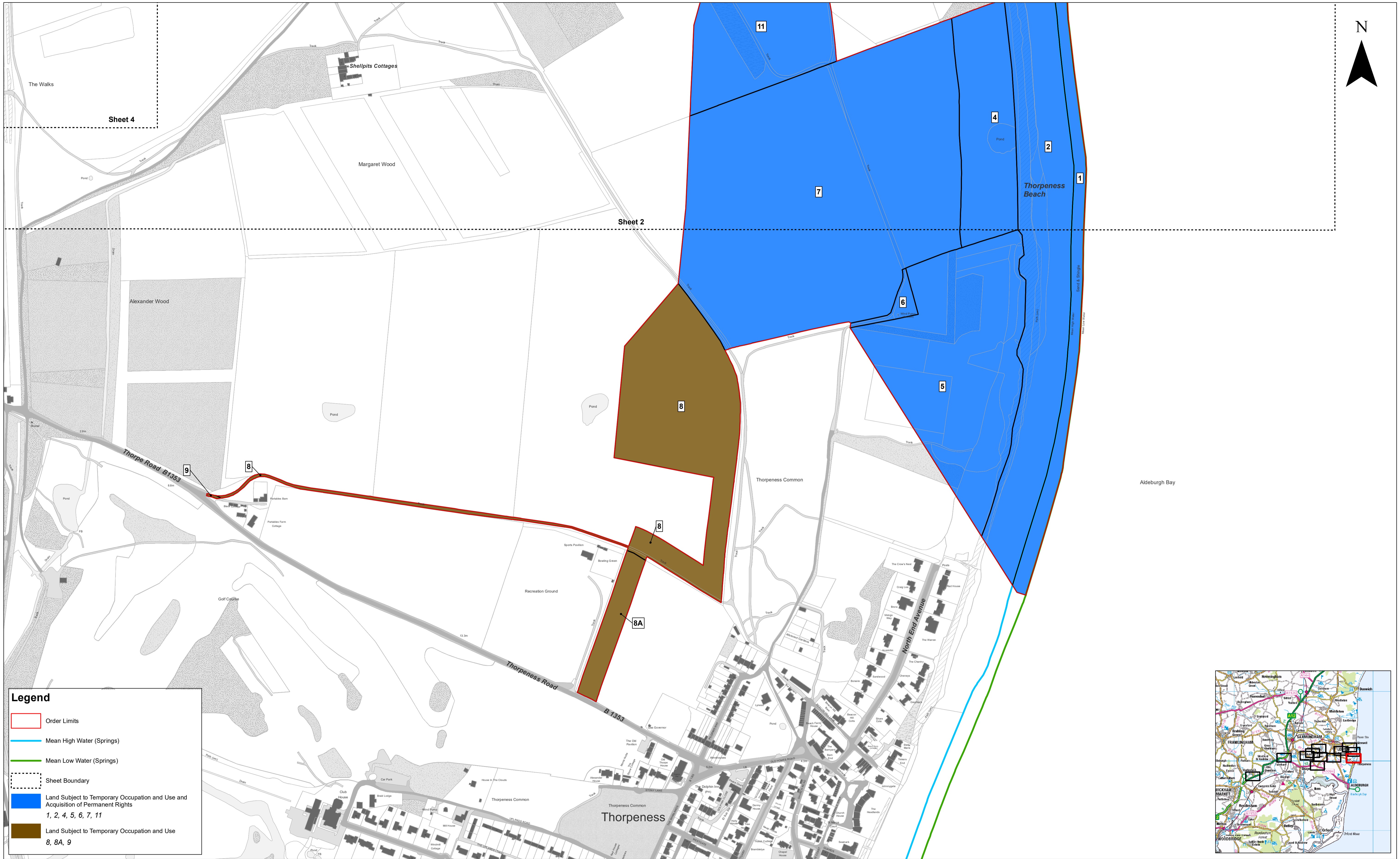

06	21/05/2021	PR	Sixth Issue - Removed plot 10, amended Plots 12 and 13
05	16/04/2021	PR	Fifth Issue - Amended Plot 13
01	07/10/2019	PR	First Issue
Rev	Date	By	Comment

Prepared:	PR
Checked:	IM
Approved:	HH

1:2,500
Scale @ A1

0 50 100 200 Metres

Coords: 647,182 260,382

Source: © Crown copyright and database rights 2020. Ordnance Survey 0100031673.
This map has been produced to the latest known information at the time of issue, and has been produced for your information only. Please consult with the SPR GIS team to ensure the content is still current before using the information contained on this map. To the fullest extent permitted by law, we accept no responsibility or liability (whether in contract, tort (including negligence) or otherwise in respect of any errors or omissions in the information contained in the map and shall not be liable for any loss, damage or expense caused by such errors or omissions.

East Anglia ONE North Offshore Wind Farm

Land Plans (Onshore)
Sheet Number: Sheet 1 of 12

Drg No	180476_PLN_DCO_1820.1	
Rev	06	British National Grid OSGB36
Date	21/05/2021	
APFP Ref: 5(2)(i)		Doc ref: 2.2.2

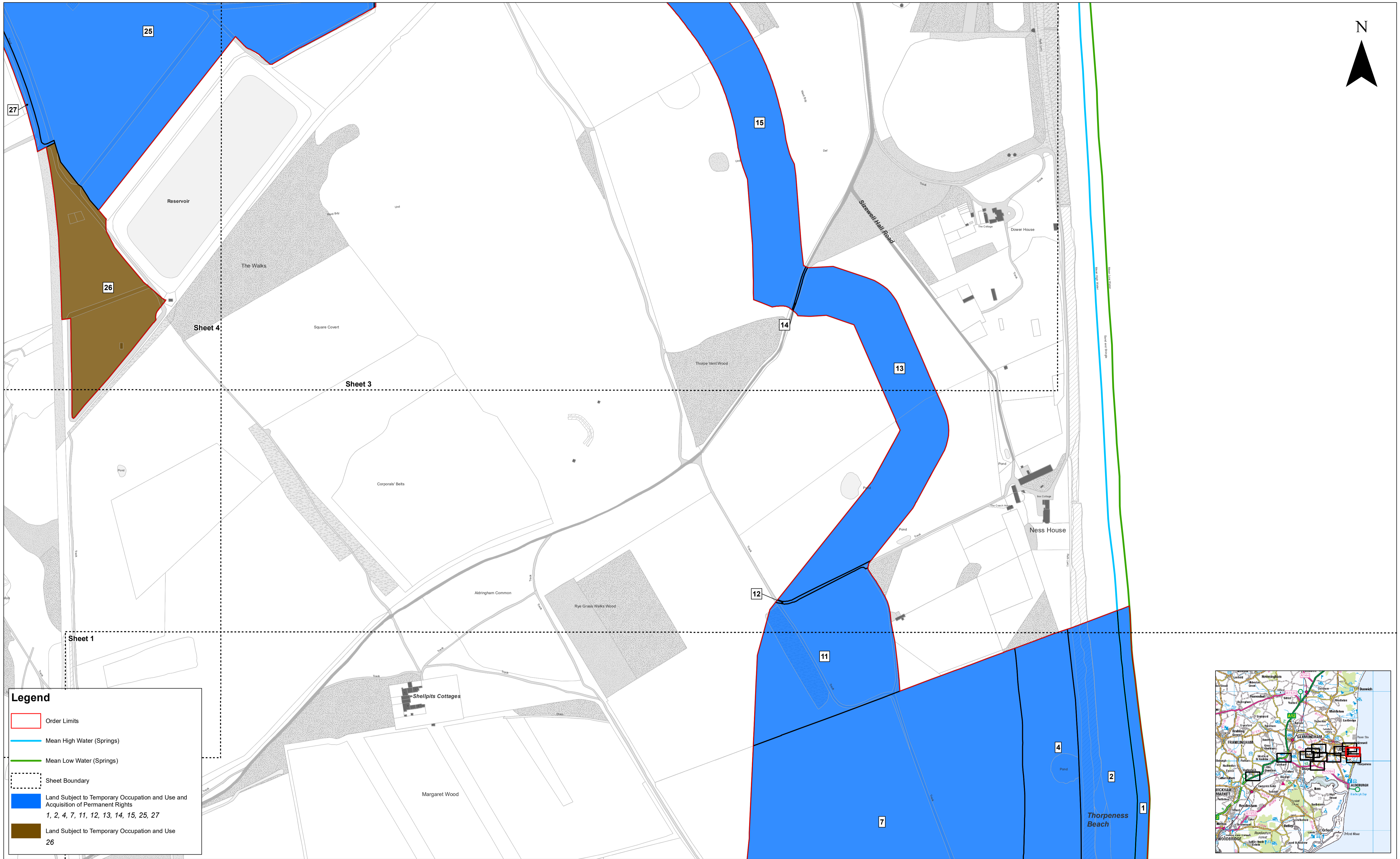

Legend

- Order Limits
- Mean High Water (Springs)
- Mean Low Water (Springs)
- Sheet Boundary
- Land Subject to Temporary Occupation and Use and Acquisition of Permanent Rights
1, 2, 4, 7, 11, 12, 13, 14, 15, 25, 27
- Land Subject to Temporary Occupation and Use
26

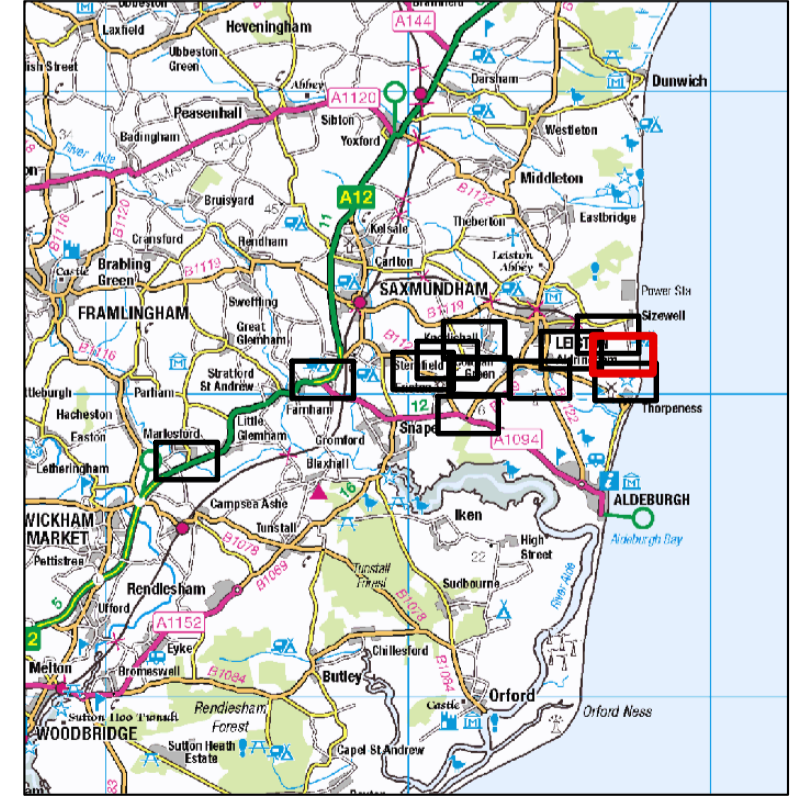

Rev	Date	By	Comment
06	21/05/2021	PR	Sixth Issue - Removed plot 10, amended Plots 12 and 13
05	16/04/2021	PR	Fifth Issue - Amended Plot 13
01	07/10/2019	PR	First Issue

Prepared: PR
Checked: IM
Approved: HH

Scale @ A1
1:2,500
0 50 100 200 Metres
Coords: 647,090 261,289
Source: © Crown copyright and database rights 2020. Ordnance Survey 0100031673.
This map has been produced to the latest known information at the time of issue, and has been produced for your information only. Please consult with the SPR GIS team to ensure the content is still current before using the information contained on this map. To the fullest extent permitted by law, we accept no responsibility or liability (whether in contract, tort (including negligence) or otherwise in respect of any errors or omissions in the information contained in the map and shall not be liable for any loss, damage or expense caused by such errors or omissions.

East Anglia ONE North Offshore Wind Farm
Land Plans (Onshore)
Sheet Number: Sheet 2 of 12

Drg No	180476_PLN_DCO_1820.2	
Rev	06	British National Grid OSGB36
Date	21/05/2021	
APFP Ref: 5(2)(i)		Doc ref: 2.2.2

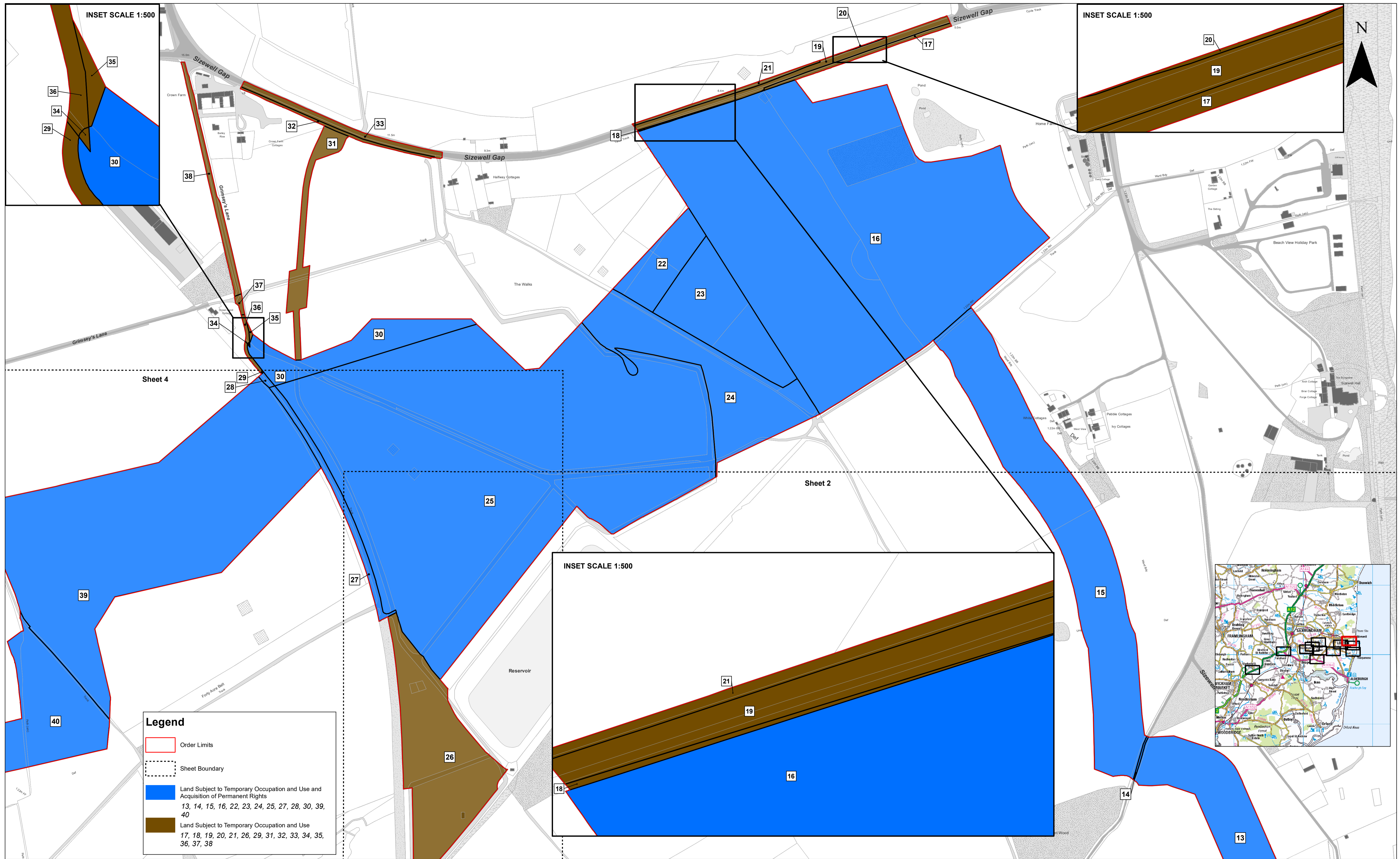

Legend

- Order Limits
- Sheet Boundary
- Land Subject to Temporary Occupation and Use and Acquisition of Permanent Rights
13, 14, 15, 16, 22, 23, 24, 25, 27, 28, 30, 39, 40
- Land Subject to Temporary Occupation and Use
17, 18, 19, 20, 21, 26, 29, 31, 32, 33, 34, 35, 36, 37, 38

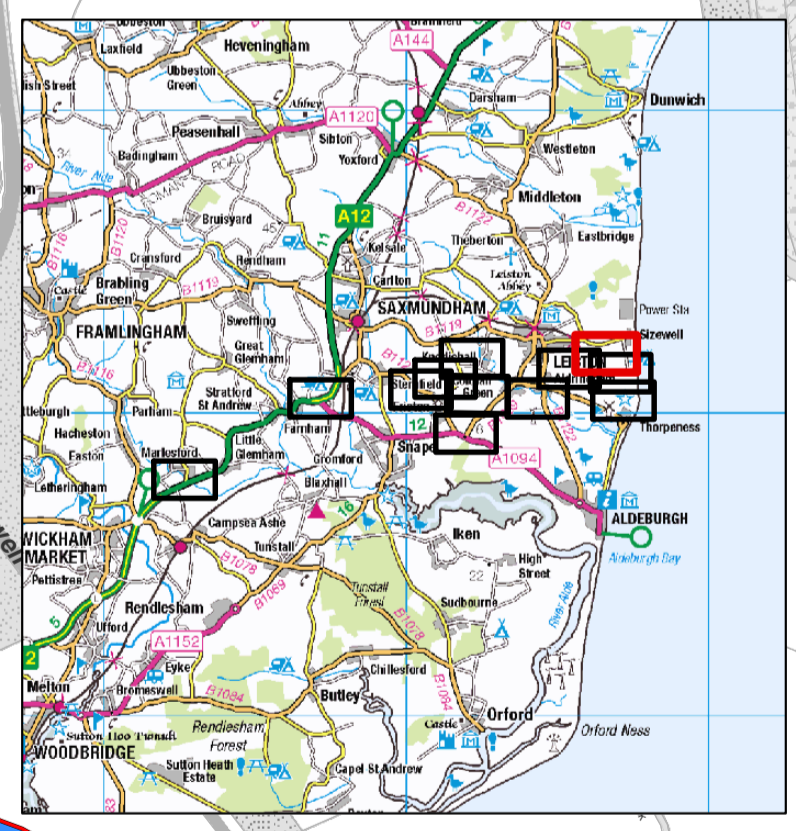
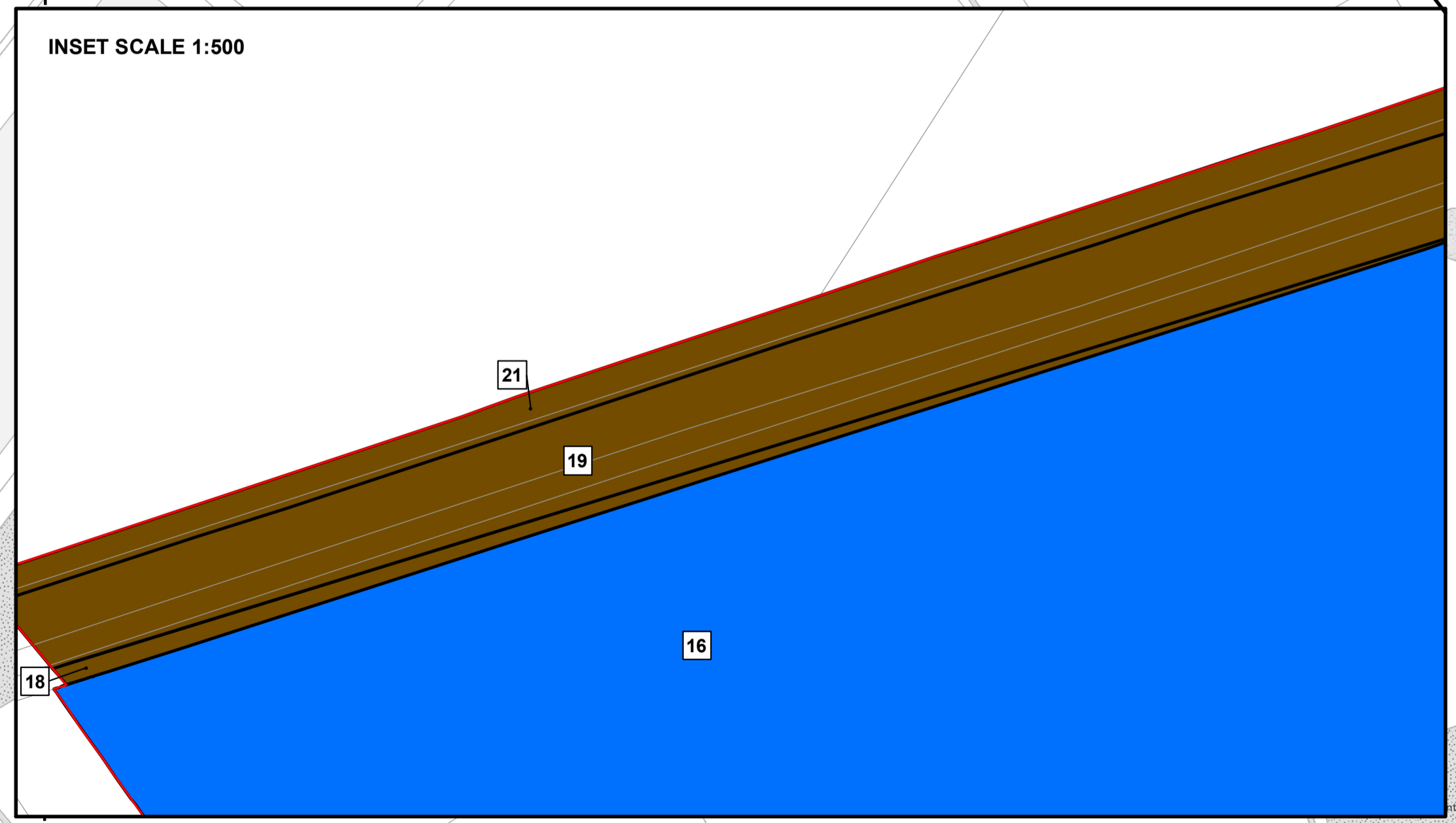

Rev	Date	By	Comment
06	21/05/2021	PR	Sixth Issue - Removed plot 10, amended Plots 12 and 13
05	16/04/2021	PR	Fifth Issue - Amended Plot 13
01	07/10/2019	PR	First Issue

Prepared: PR
Checked: IM
Approved: HH

Scale @ A1: 1:2,500
0 50 100 200 Metres

Coords: 646,599 261,965

Source: © Crown copyright and database rights 2020. Ordnance Survey 0100031673.
This map has been produced to the latest known information at the time of issue, and has been produced for your information only. Please consult with the SPR GIS team to ensure the content is still current before using the information contained on this map. To the fullest extent permitted by law, we accept no responsibility or liability (whether in contract, tort (including negligence) or otherwise) in respect of any errors or omissions in the information contained in the map and shall not be liable for any loss, damage or expense caused by such errors or omissions.

East Anglia ONE North Offshore Wind Farm
Land Plans (Onshore)
Sheet Number: Sheet 3 of 12

Drg No	Rev	Date	APFP Ref: 5(2)(i)
180476_PLN_DCO_1820.3	06	21/05/2021	Doc ref: 2.2.2

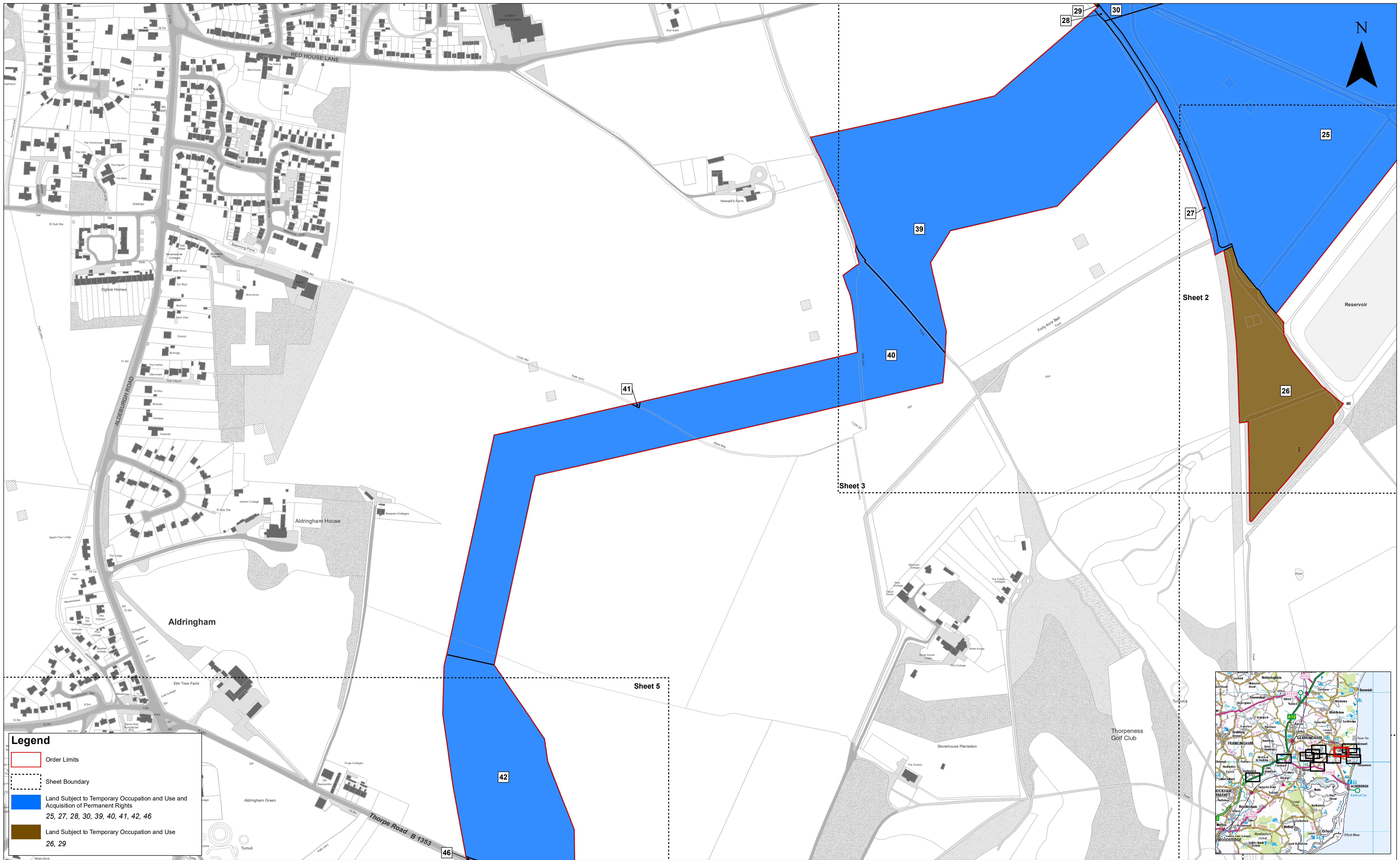

06	21/05/2021	PR	Sixth Issue - Removed plot 10, amended Plots 12 and 13
05	16/04/2021	PR	Fifth Issue - Amended Plot 13
01	07/10/2019	PR	First Issue
Rev	Date	By	Comment

Prepared:	PR
Checked:	IM
Approved:	HH

1:2,500
Scale @ A1

0 50 100 200 Metres

Coords: 645,393 261,437

Source: © Crown copyright and database rights 2020. Ordnance Survey 0100031673.
This map has been produced to the latest known information at the time of issue, and has been produced for your information only. Please consult with the SPR GIS team to ensure the content is still current before using the information contained on this map. To the fullest extent permitted by law, we accept no responsibility or liability (whether in contract, tort (including negligence) or otherwise in respect of any errors or omissions in the information contained in the map and shall not be liable for any loss, damage or expense caused by such errors or omissions.

East Anglia ONE North Offshore Wind Farm

Land Plans (Onshore)
Sheet Number: Sheet 4 of 12

Drg No	180476_PLN_DCO_1820.4	
Rev	06	British National Grid OSGB36
Date	21/05/2021	
APFP Ref: 5(2)(i)		Doc ref: 2.2.2

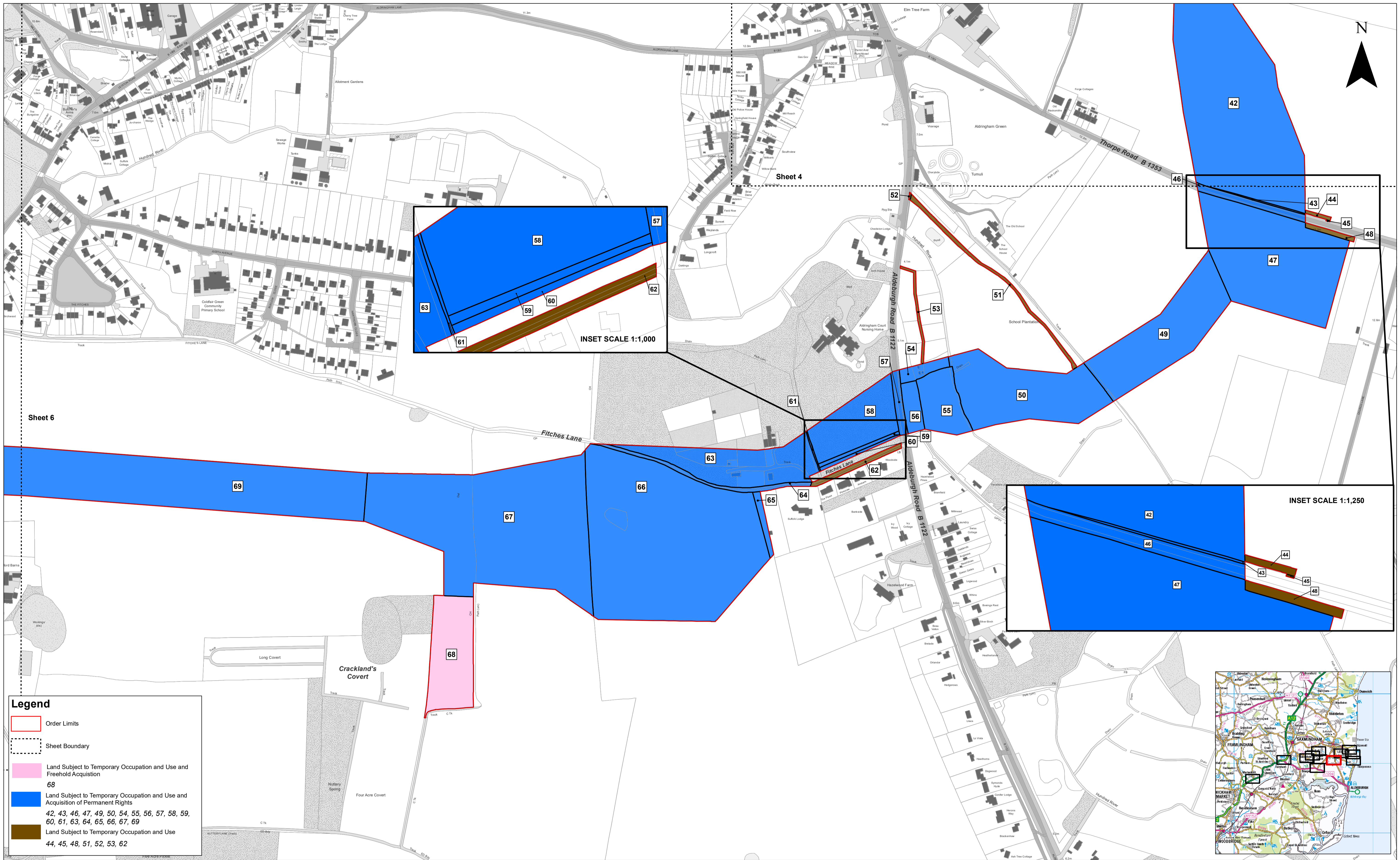

Legend

	Order Limits
	Sheet Boundary
	Land Subject to Temporary Occupation and Use and Freehold Acquisition 68
	Land Subject to Temporary Occupation and Use and Acquisition of Permanent Rights 42, 43, 46, 47, 49, 50, 54, 55, 56, 57, 58, 59, 60, 61, 63, 64, 65, 66, 67, 69
	Land Subject to Temporary Occupation and Use 44, 45, 48, 51, 52, 53, 62

Rev	Date	By	Comment
06	21/05/2021	PR	Sixth Issue - Removed plot 10, amended Plots 12 and 13
05	16/04/2021	PR	Fifth Issue - Amended Plot 13
01	07/10/2019	PR	First Issue

Prepared:	PR
Checked:	IM
Approved:	HH

1:2,500
Scale @ A1

0 50 100 200 Metres

Coords: 644,341 260,466

Source: © Crown copyright and database rights 2020. Ordnance Survey 0100031673.
This map has been produced to the latest known information at the time of issue, and has been produced for your information only. Please consult with the SPR GIS team to ensure the content is still current before using the information contained on this map. To the fullest extent permitted by law, we accept no responsibility or liability (whether in contract, tort (including negligence) or otherwise in respect of any errors or omissions in the information contained in the map and shall not be liable for any loss, damage or expense caused by such errors or omissions.

East Anglia ONE North Offshore Wind Farm
Land Plans (Onshore)
Sheet Number: Sheet 5 of 12

Drg No	180476_PLN_DCO_1820.5	
Rev	06	British National Grid OSGB36
Date	21/05/2021	
APFP Ref: 5(2)(i)		Doc ref: 2.2.2

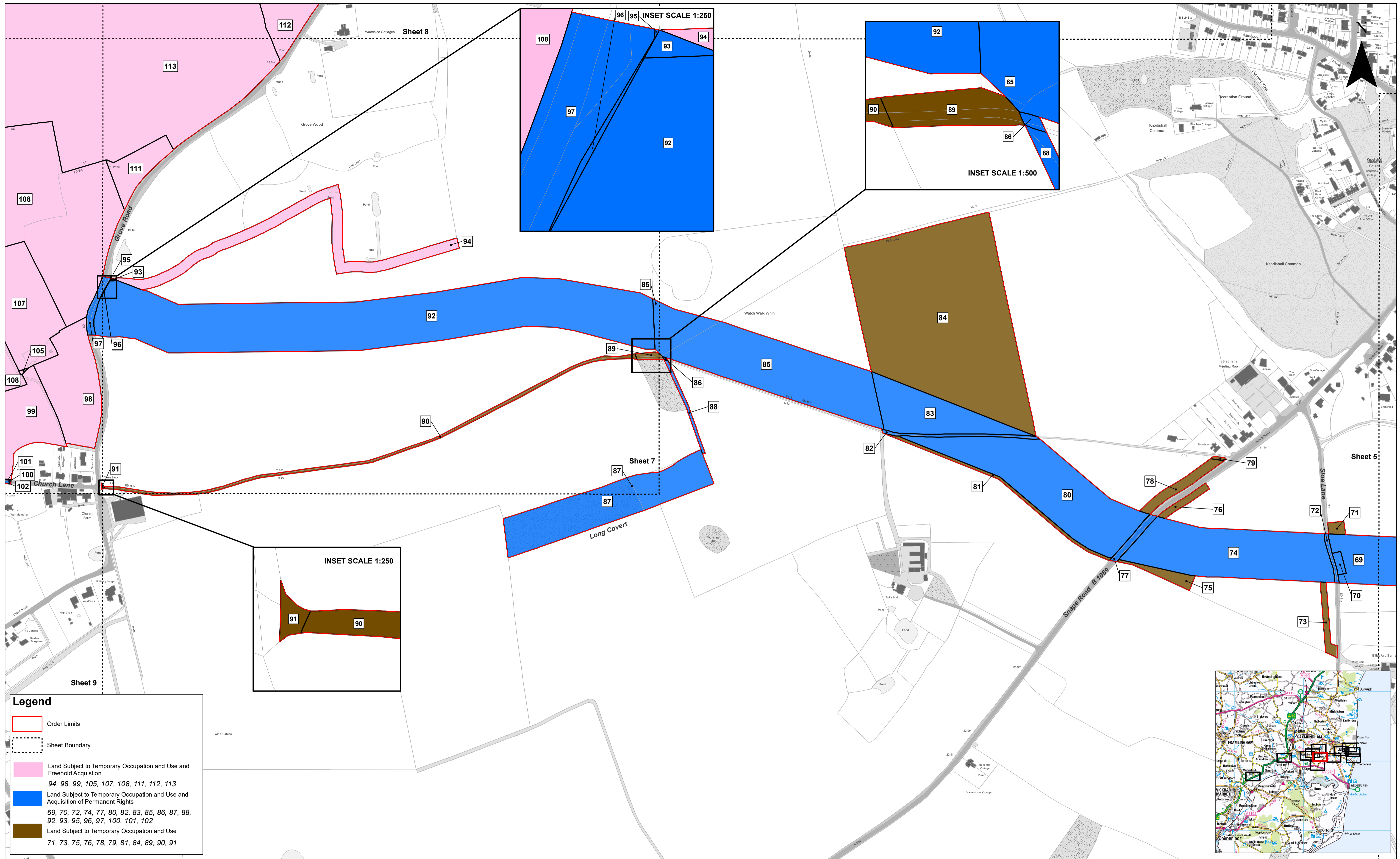

Legend	
	Order Limits
	Sheet Boundary
	Land Subject to Temporary Occupation and Use and Freehold Acquisition 94, 98, 99, 105, 107, 108, 111, 112, 113
	Land Subject to Temporary Occupation and Use and Acquisition of Permanent Rights 69, 70, 72, 74, 77, 80, 82, 83, 85, 86, 87, 88, 92, 93, 95, 96, 97, 100, 101, 102
	Land Subject to Temporary Occupation and Use 71, 73, 75, 76, 78, 79, 81, 84, 89, 90, 91

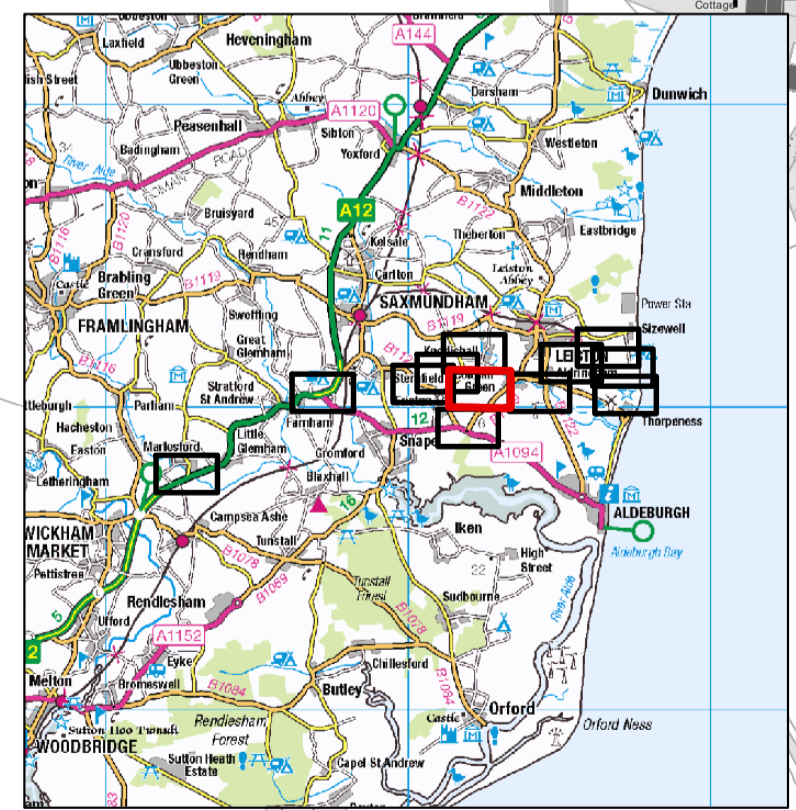

Rev	Date	By	Comment
06	21/05/2021	PR	Sixth Issue - Removed plot 10, amended Plots 12 and 13
05	16/04/2021	PR	Fifth Issue - Amended Plot 13
01	07/10/2019	PR	First Issue

Prepared:	PR
Checked:	IM
Approved:	HH

1:2,500
Scale @ A1

Metres

Coords: 642,357 260,597

Source: © Crown copyright and database rights 2020. Ordnance Survey 0100031673.
This map has been produced to the latest known information at the time of issue, and has been produced for your information only. Please consult with the SPR GIS team to ensure the content is still current before using the information contained on this map. To the fullest extent permitted by law, we accept no responsibility or liability (whether in contract, tort (including negligence) or otherwise in respect of any errors or omissions in the information contained in the map and shall not be liable for any loss, damage or expense caused by such errors or omissions.

East Anglia ONE North Offshore Wind Farm

Land Plans (Onshore)
Sheet Number: Sheet 6 of 12

Drg No	180476_PLN_DCO_1820.6	
Rev	06	British National Grid OSGB36
Date	21/05/2021	
APFP Ref: 5(2)(i)		Doc ref: 2.2.2

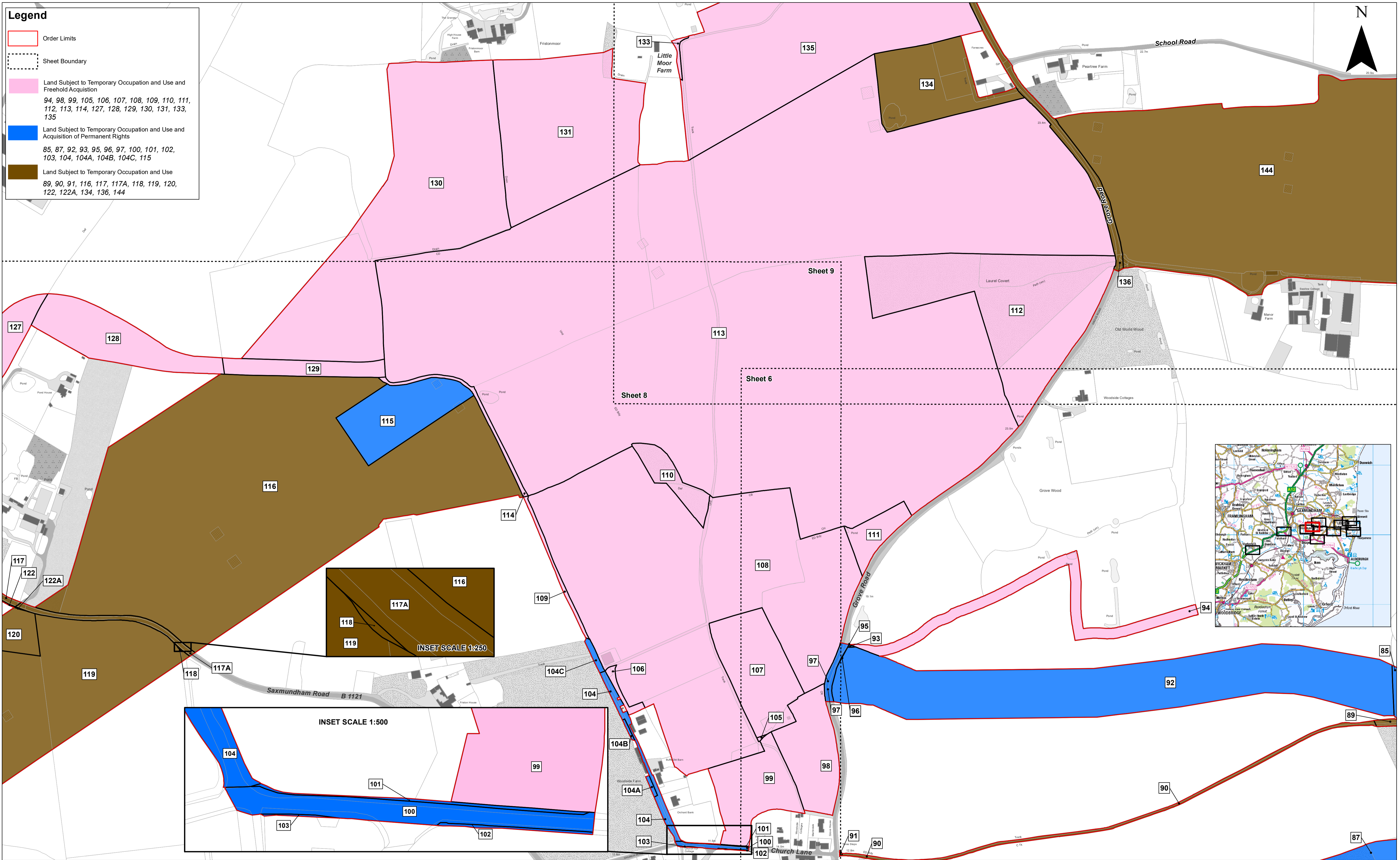

Legend

- Order Limits
- Sheet Boundary
- Land Subject to Temporary Occupation and Use and Freehold Acquisition
94, 98, 99, 105, 106, 107, 108, 109, 110, 111, 112, 113, 114, 127, 128, 129, 130, 131, 133, 135
- Land Subject to Temporary Occupation and Use and Acquisition of Permanent Rights
85, 87, 92, 93, 95, 96, 97, 100, 101, 102, 103, 104, 104A, 104B, 104C, 115
- Land Subject to Temporary Occupation and Use
89, 90, 91, 116, 117, 117A, 118, 119, 120, 122, 122A, 134, 136, 144

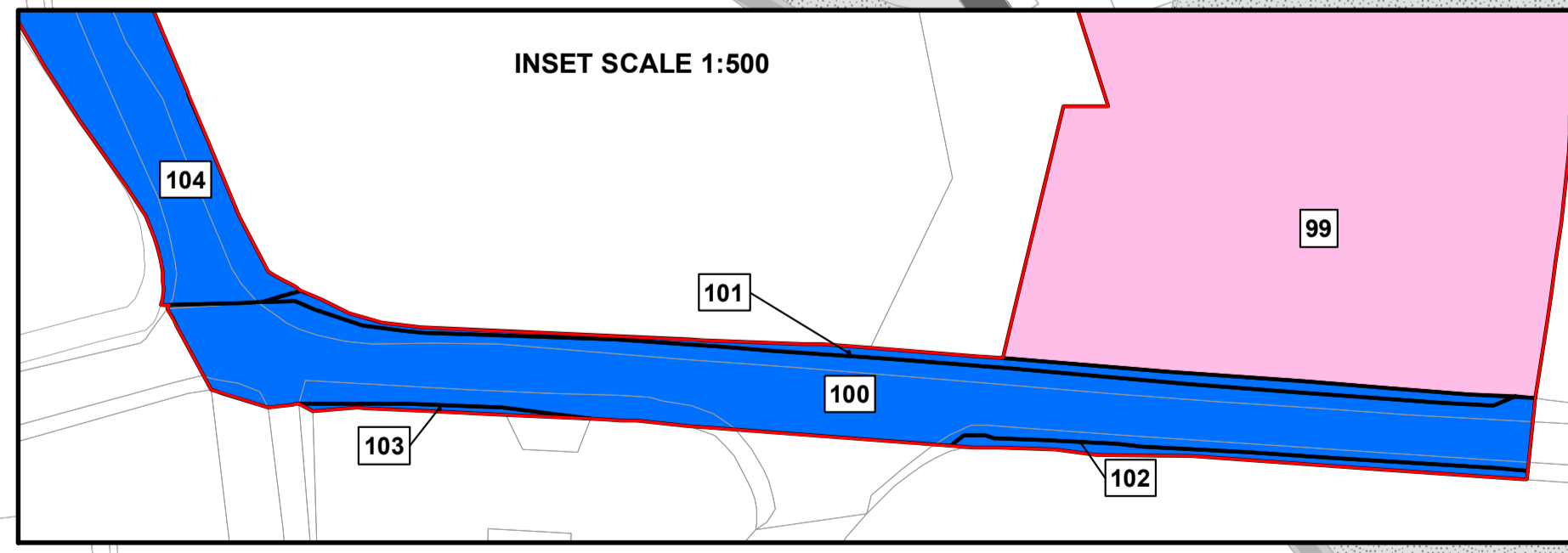
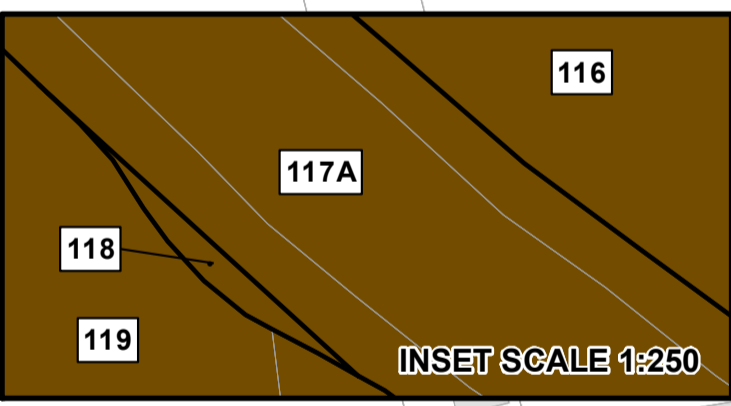
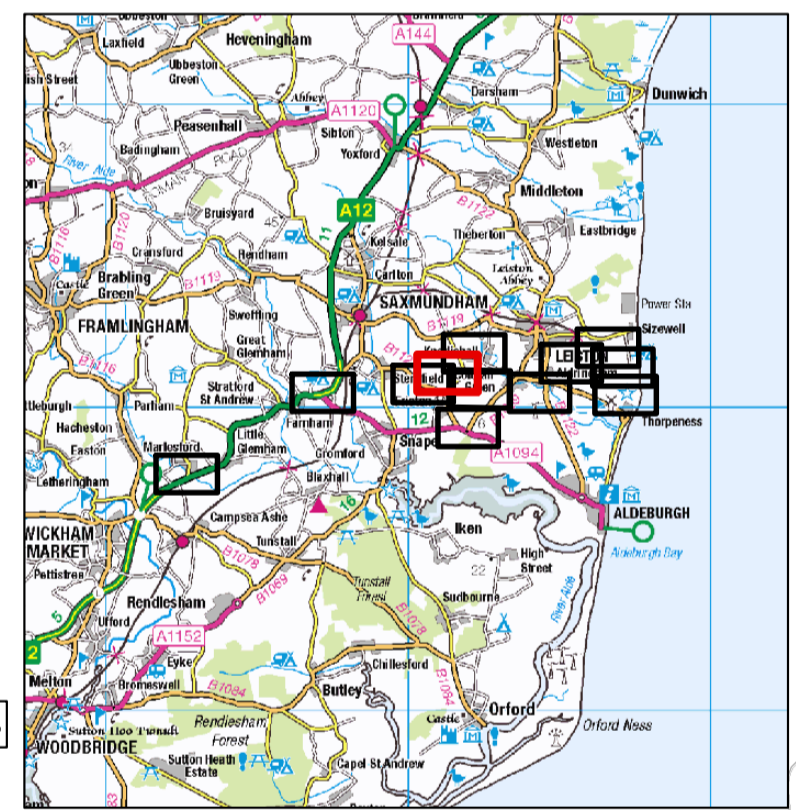

Rev	Date	By	Comment
06	21/05/2021	PR	Sixth Issue - Removed plot 10, amended Plots 12 and 13
05	16/04/2021	PR	Fifth Issue - Amended Plot 13
01	07/10/2019	PR	First Issue

Scale @ A1
1:2,500
0 50 100 200 Metres

Coords: 641,291 261,125

Source: © Crown copyright and database rights 2020. Ordnance Survey 0100031673.
This map has been produced to the latest known information at the time of issue, and has been produced for your information only. Please consult with the SPR GIS team to ensure the content is still current before using the information contained on this map. To the fullest extent permitted by law, we accept no responsibility or liability (whether in contract, tort (including negligence) or otherwise in respect of any errors or omissions in the information contained in the map and shall not be liable for any loss, damage or expense caused by such errors or omissions.

East Anglia ONE North Offshore Wind Farm
Land Plans (Onshore)
Sheet Number: Sheet 7 of 12

Drg No	Rev	Date	APFP Ref: 5(2)(i)
180476_PLN_DCO_1820.7	06	21/05/2021	Doc ref: 2.2.2

Legend

- Order Limits
- Sheet Boundary
- Land Subject to Temporary Occupation and Use and Freehold Acquisition
112, 113, 131, 133, 135
- Land Subject to Temporary Occupation and Use
134, 136, 144, 146, 147

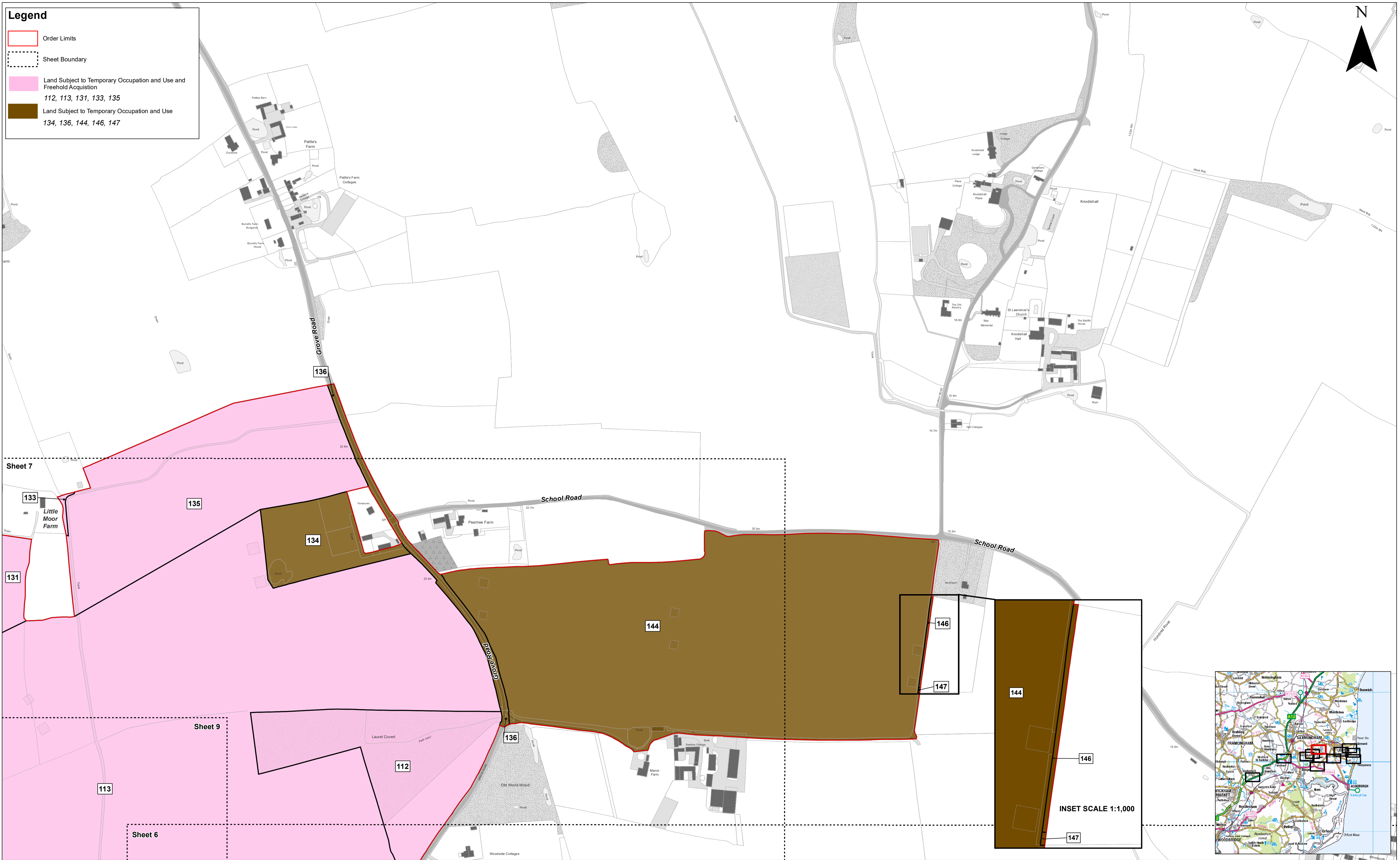

Rev	Date	By	Comment
06	21/05/2021	PR	Sixth Issue - Removed plot 10, amended Plots 12 and 13
05	16/04/2021	PR	Fifth Issue - Amended Plot 13
01	07/10/2019	PR	First Issue

Prepared:	PR
Checked:	IM
Approved:	HH

1:2,500
Scale @ A1

Coords: 642,174 261,780

Source: © Crown copyright and database rights 2020. Ordnance Survey 0100031673.
This map has been produced to the latest known information at the time of issue, and has been produced for your information only. Please consult with the SPR GIS team to ensure the content is still current before using the information contained on this map. To the fullest extent permitted by law, we accept no responsibility or liability (whether in contract, tort (including negligence) or otherwise in respect of any errors or omissions in the information contained in the map and shall not be liable for any loss, damage or expense caused by such errors or omissions.

East Anglia ONE North Offshore Wind Farm
Land Plans (Onshore)
Sheet Number: Sheet 8 of 12

Drg No	180476_PLN_DCO_1820.8	
Rev	06	British National Grid OSGB36
Date	21/05/2021	
APFP Ref: 5(2)(i)		Doc ref: 2.2.2

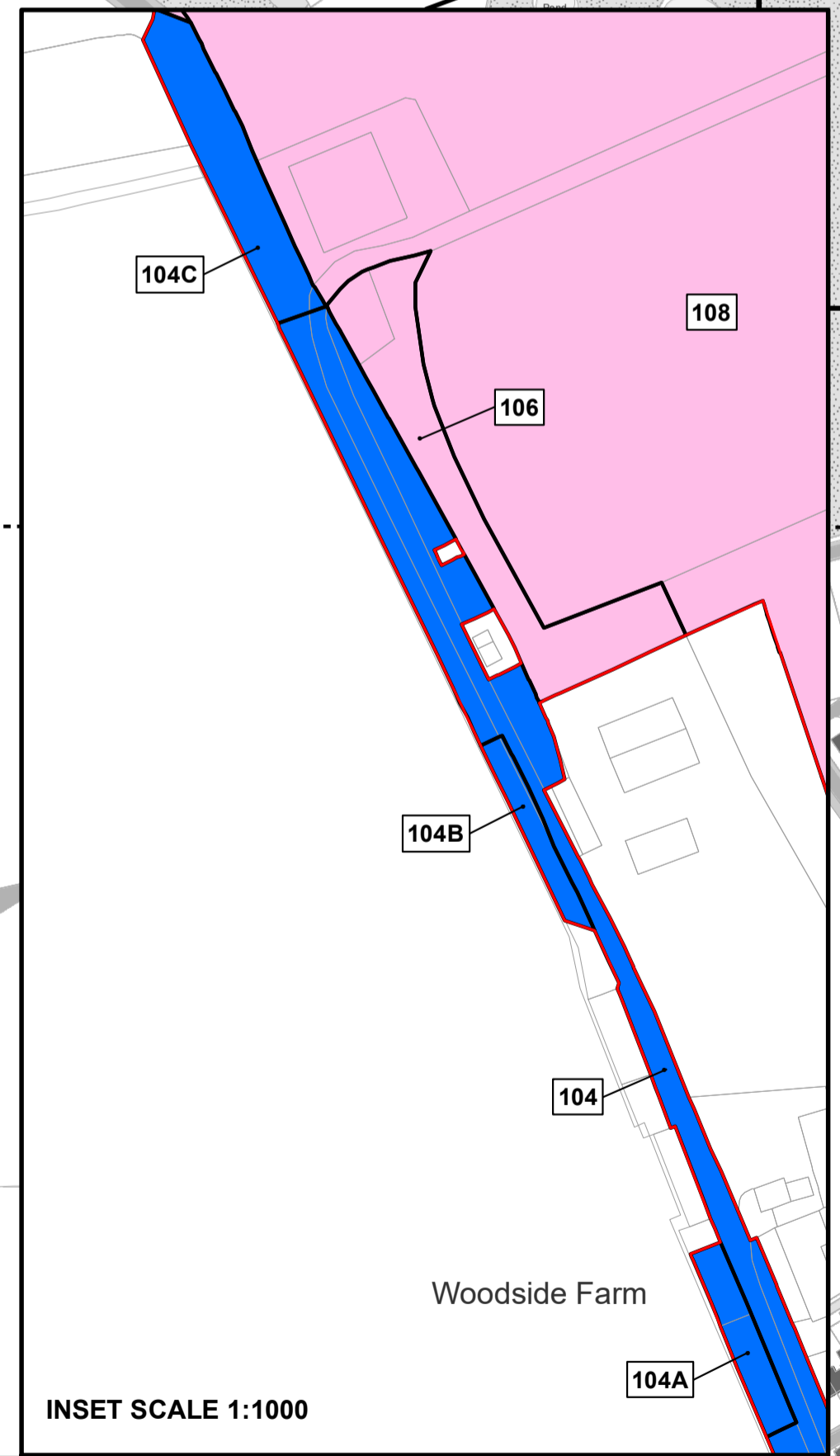
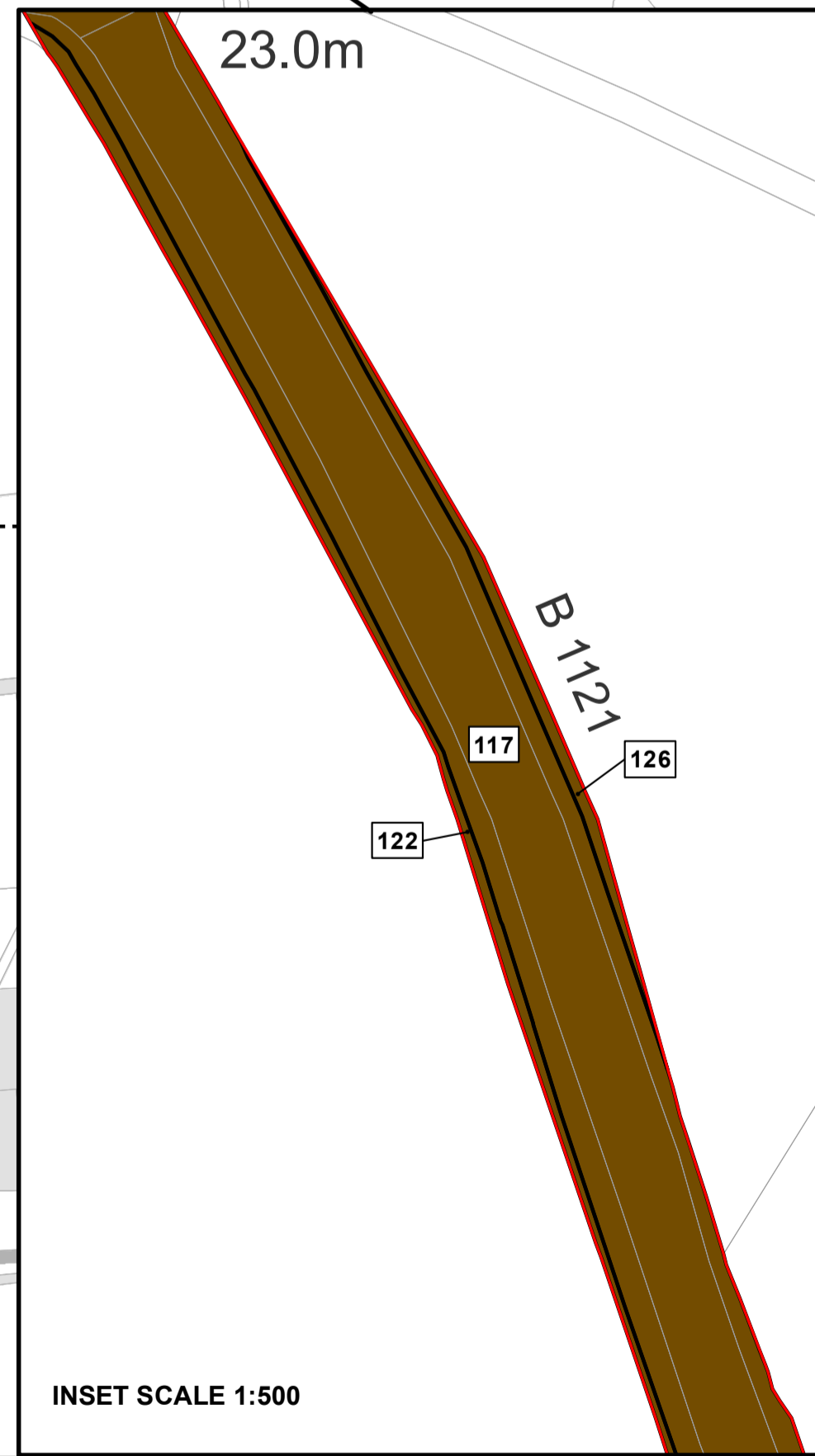
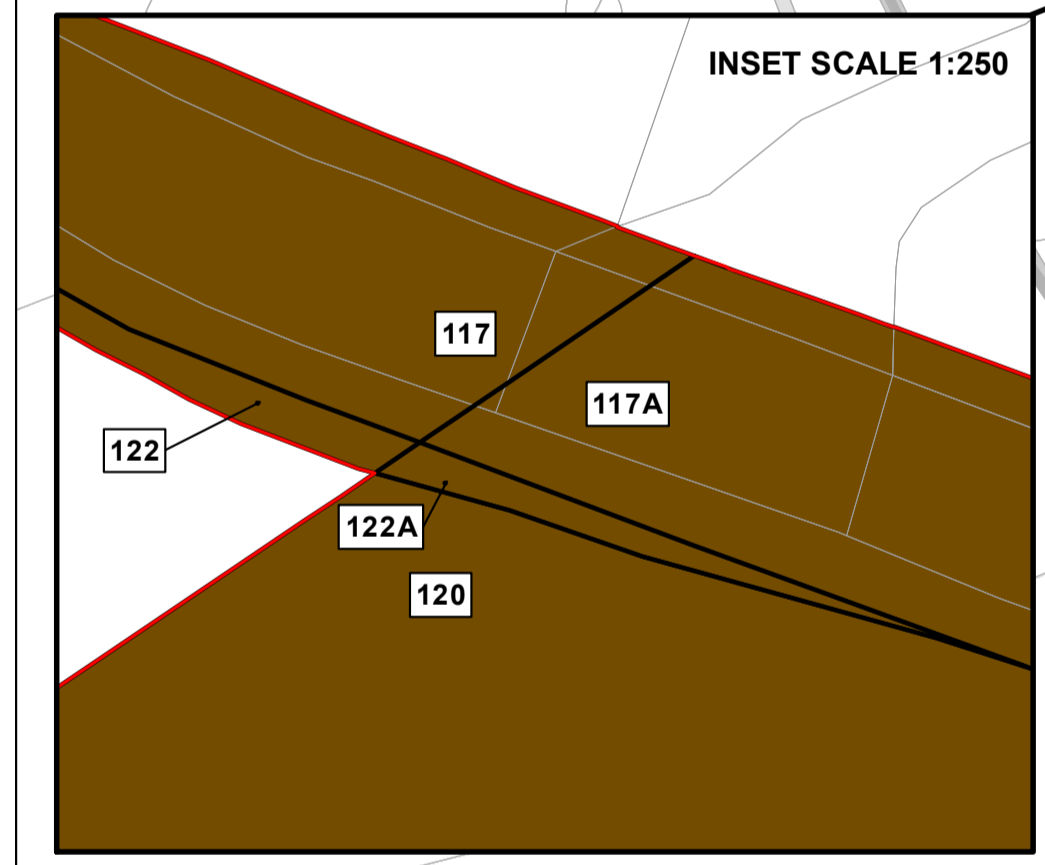
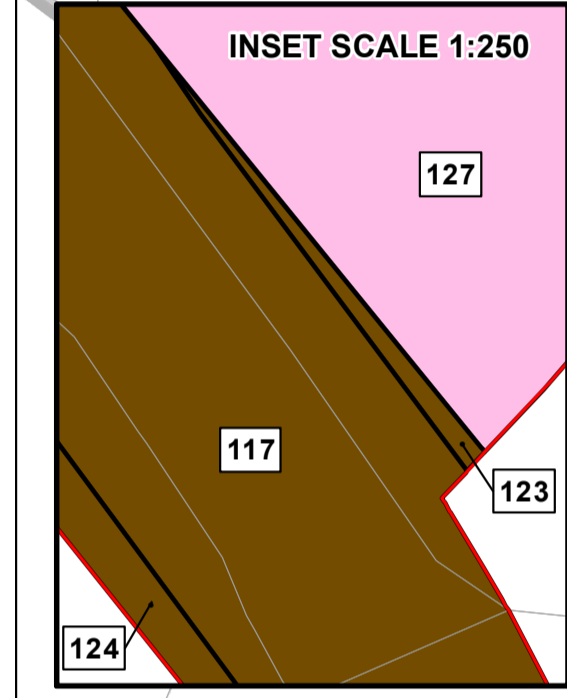
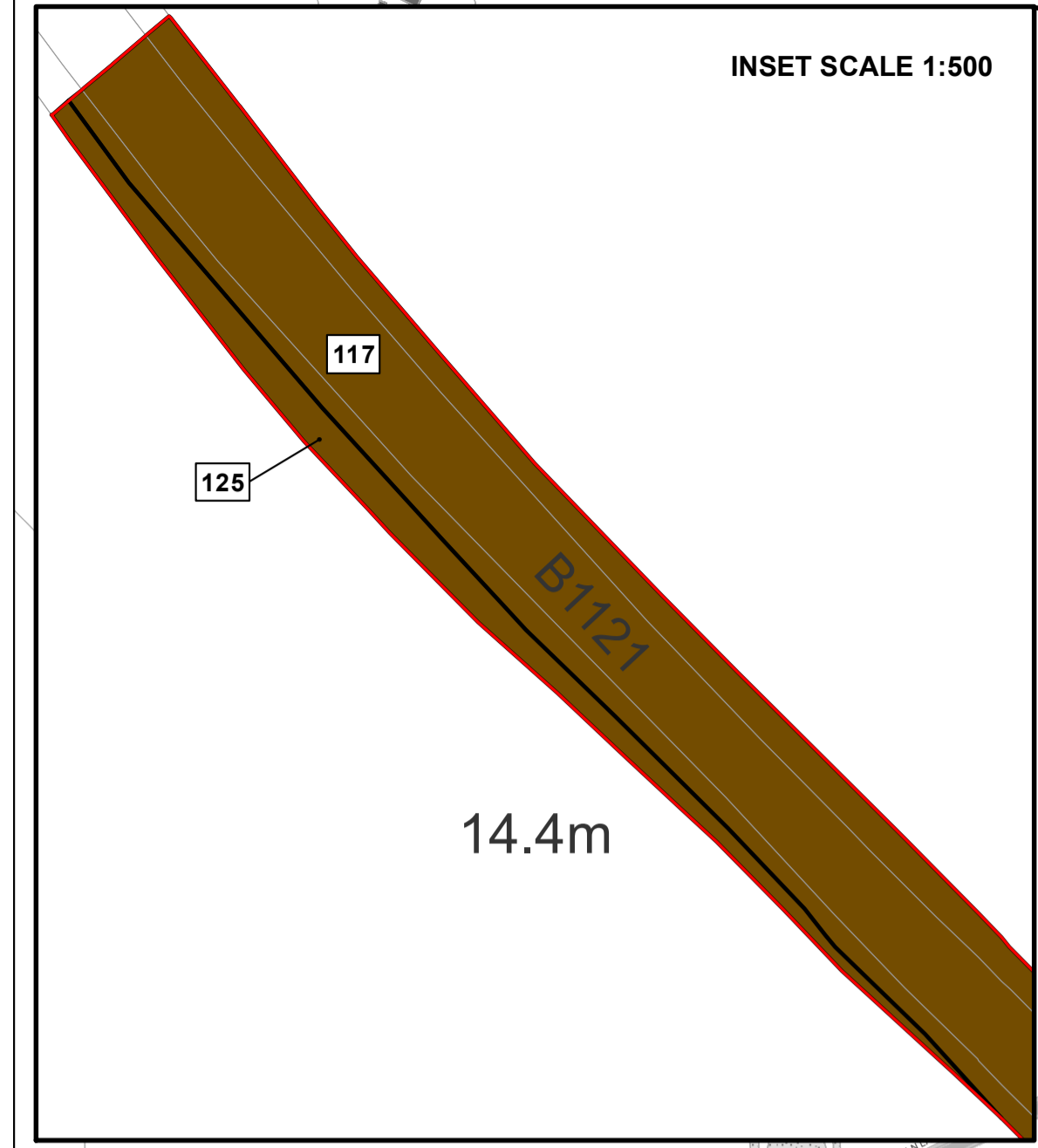
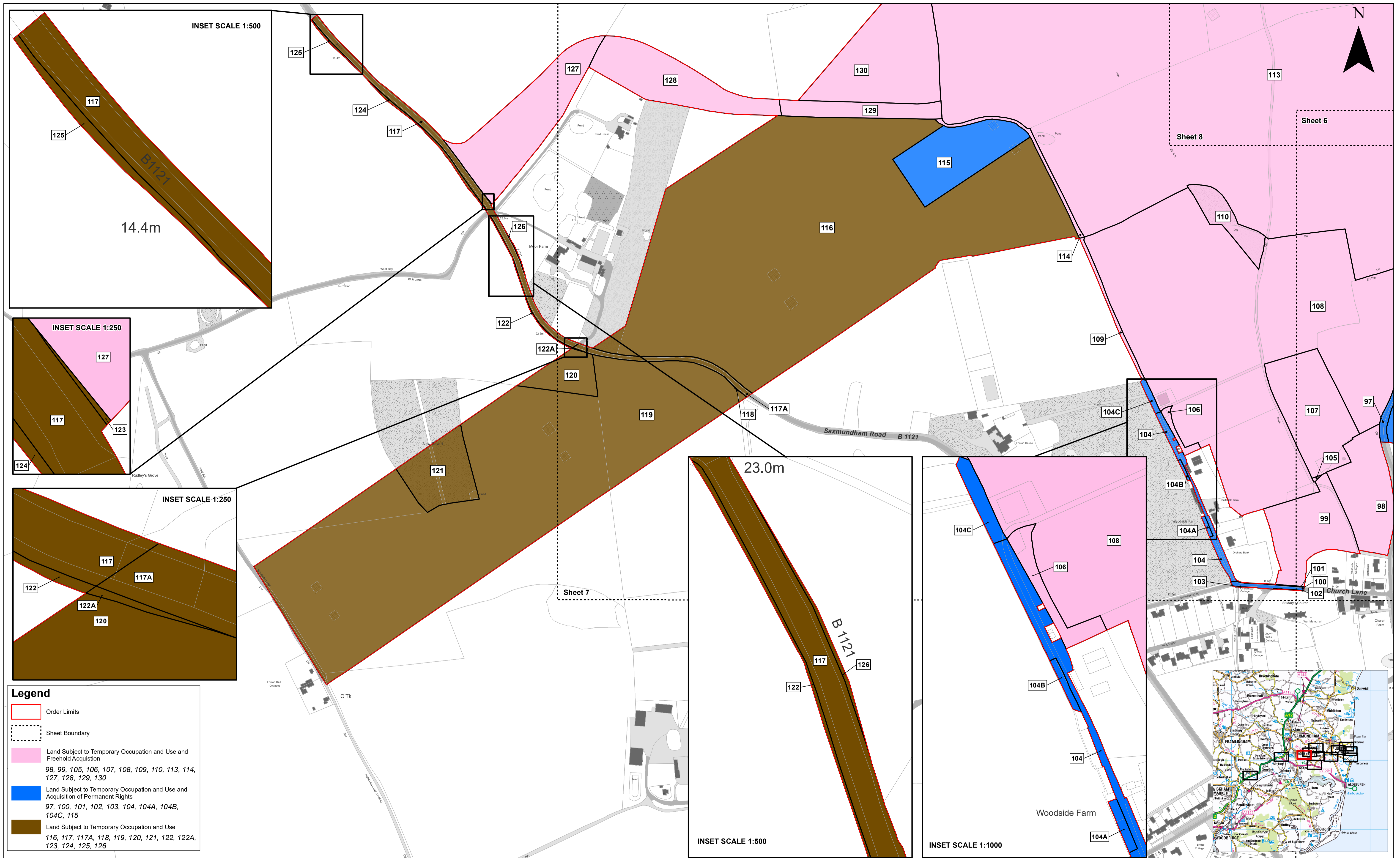

Legend

- Order Limits
- Sheet Boundary
- Land Subject to Temporary Occupation and Use and Freehold Acquisition
98, 99, 105, 106, 107, 108, 109, 110, 113, 114, 127, 128, 129, 130
- Land Subject to Temporary Occupation and Use and Acquisition of Permanent Rights
97, 100, 101, 102, 103, 104, 104A, 104B, 104C, 115
- Land Subject to Temporary Occupation and Use
116, 117, 117A, 118, 119, 120, 121, 122, 122A, 123, 124, 125, 126



Rev	Date	By	Comment
06	21/05/2021	PR	Sixth Issue - Removed plot 10, amended Plots 12 and 13
05	16/04/2021	PR	Fifth Issue - Amended Plot 13
01	07/10/2019	PR	First Issue

Prepared:	PR
Checked:	IM
Approved:	HH

1:2,500
Scale @ A1

0 50 100 200 Metres

Coords: 640,488 260,753

Source: © Crown copyright and database rights 2020. Ordnance Survey 0100031673.
This map has been produced to the latest known information at the time of issue, and has been produced for your information only. Please consult with the SPR GIS team to ensure the content is still current before using the information contained on this map. To the fullest extent permitted by law, we accept no responsibility or liability (whether in contract, tort (including negligence) or otherwise in respect of any errors or omissions in the information contained in the map and shall not be liable for any loss, damage or expense caused by such errors or omissions.

East Anglia ONE North Offshore Wind Farm

Land Plans (Onshore)
Sheet Number: Sheet 9 of 12

Drg No	180476_PLN_DCO_1820.9	
Rev	06	British National Grid OSGB36
Date	21/05/2021	
APFP Ref: 5(2)(i)		Doc ref: 2.2.2



Legend

- Order Limits
- Sheet Boundary
- Land Subject to Temporary Occupation and Use
148, 149, 150, 151, 152, 153, 154, 155, 156, 157, 158

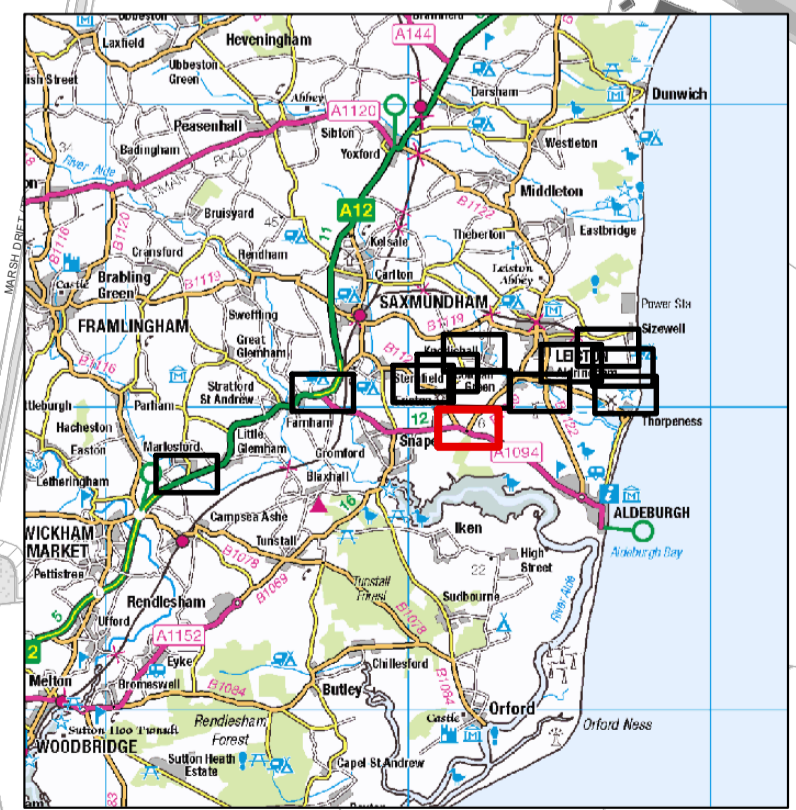

Rev	Date	By	Comment
06	21/05/2021	PR	Sixth Issue - Removed plot 10, amended Plots 12 and 13
05	16/04/2021	PR	Fifth Issue - Amended Plot 13
01	07/10/2019	PR	First Issue

Prepared:	PR
Checked:	IM
Approved:	HH

Scale @ A1: 1:2,500

0 50 100 200 Metres

Coords: 641,971 259,324

Source: © Crown copyright and database rights 2020. Ordnance Survey 0100031673.
This map has been produced to the latest known information at the time of issue, and has been produced for your information only. Please consult with the SPR GIS team to ensure the content is still current before using the information contained on this map. To the fullest extent permitted by law, we accept no responsibility or liability (whether in contract, tort (including negligence) or otherwise in respect of any errors or omissions in the information contained in the map and shall not be liable for any loss, damage or expense caused by such errors or omissions.

East Anglia ONE North Offshore Wind Farm

Land Plans (Onshore)
Sheet Number: Sheet 10 of 12

Drg No	180476_PLN_DCO_1820.10	
Rev	06	British National Grid OSGB36
Date	21/05/2021	
APFP Ref: 5(2)(i)		Doc ref: 2.2.2



Legend

- Order Limits
- Sheet Boundary
- Land Subject to Temporary Occupation and Use
159, 160, 163, 164, 165, 166, 167, 168, 169, 170, 171, 172, 173, 174, 175, 176



Rev	Date	By	Comment
06	21/05/2021	PR	Sixth Issue - Removed plot 10, amended Plots 12 and 13
05	16/04/2021	PR	Fifth Issue - Amended Plot 13
01	07/10/2019	PR	First Issue

Prepared:	PR
Checked:	IM
Approved:	HH

1:2,500
Scale @ A1

0 50 100 200 Metres

Coords: 637,176 260,487

Source: © Crown copyright and database rights 2020. Ordnance Survey 0100031673.
This map has been produced to the latest known information at the time of issue, and has been produced for your information only. Please consult with the SPR GIS team to ensure the content is still current before using the information contained on this map. To the fullest extent permitted by law, we accept no responsibility or liability (whether in contract, tort (including negligence) or otherwise in respect of any errors or omissions in the information contained in the map and shall not be liable for any loss, damage or expense caused by such errors or omissions.

East Anglia ONE North Offshore Wind Farm

Land Plans (Onshore)
Sheet Number: Sheet 11 of 12

Drg No	180476_PLN_DCO_1820.11	
Rev	06	British National Grid OSGB36
Date	21/05/2021	
APFP Ref: 5(2)(i)		Doc ref: 2.2.2



Legend

- Order Limits
- Sheet Boundary
- Land Subject to Temporary Occupation and Use
177, 178, 179, 180, 181, 182

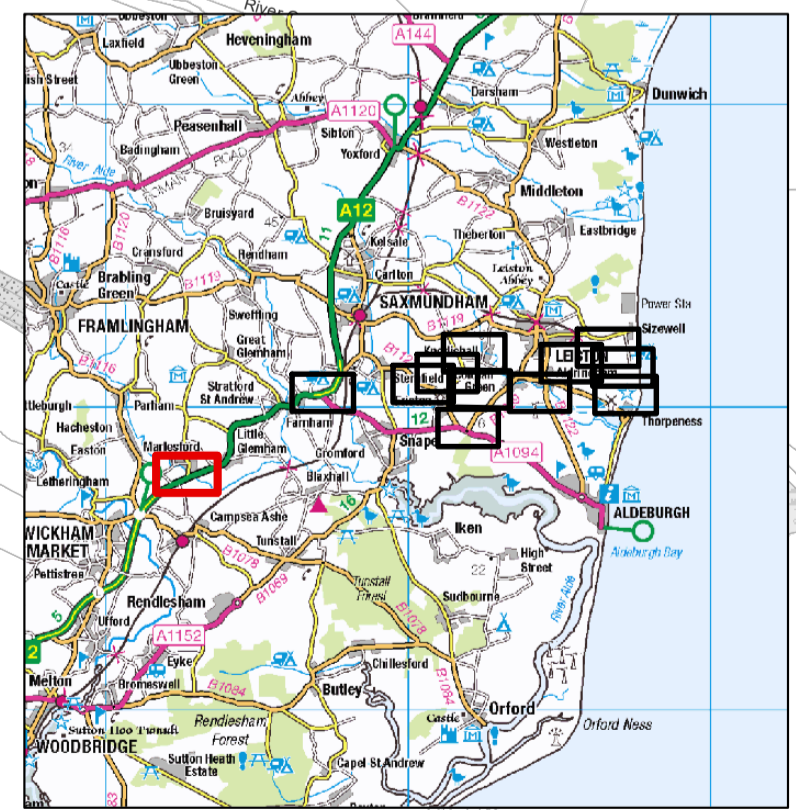

	06	21/05/2021	PR	Sixth Issue - Removed plot 10, amended Plots 12 and 13
	05	16/04/2021	PR	Fifth Issue - Amended Plot 13
	01	07/10/2019	PR	First Issue
Rev	Date	By	Comment	

Prepared:	PR
Checked:	IM
Approved:	HH

1:2,500
Scale @ A1

0 50 100 200 Metres

Coords: 632,670 257,780

Source: © Crown copyright and database rights 2020. Ordnance Survey 0100031673.
This map has been produced to the latest known information at the time of issue, and has been produced for your information only. Please consult with the SPR GIS team to ensure the content is still current before using the information contained on this map. To the fullest extent permitted by law, we accept no responsibility or liability (whether in contract, tort (including negligence) or otherwise in respect of any errors or omissions in the information contained in the map and shall not be liable for any loss, damage or expense caused by such errors or omissions.

East Anglia ONE North Offshore Wind Farm

Land Plans (Onshore)
Sheet Number: Sheet 12 of 12

Drg No	180476_PLN_DCO_1820.12	
Rev	06	British National Grid OSGB36
Date	21/05/2021	
APFP Ref: 5(2)(i)		Doc ref: 2.2.2